

# High Strength Hexsert® 39301

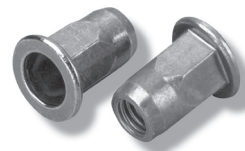

English	Français	Deutsch	Italiano	Español
Large flange	A collerette	Flachkopf	Flangiato	Ala Ancha
Hexagonal body	Hexagonal corps	Hexagonaler Schaft	Hexagonal corpo	Hexagonal cuerpo
Low carbon steel*	Acier bas carbone*	Stahl*	Acciaio a basso tenore di carbonio*	Acero bajo en carbono*
Zinc plated, thickness 10µm Clear trivalent passivated	Revêtement zingué, épaisseur 10 µm Passivation claire trivalente	Verzinkt, 10 µm Klar chromatiert, Cr6-frei	Zincatura spessore 10µm Passivazione chiara trivalente	Zincado, 10 micras Pasivado claro trivalente

~~Cr6~~



240 h\*\*

\* : SAE 1008 / EN 10263-2 C8C (DIN 10263-2 C8C, Qst 34-3)

\*\* : to red rust / à la rouille rouge / bis Rotrost / alla ruggine rossa / al óxido rojo (ASTM B117)

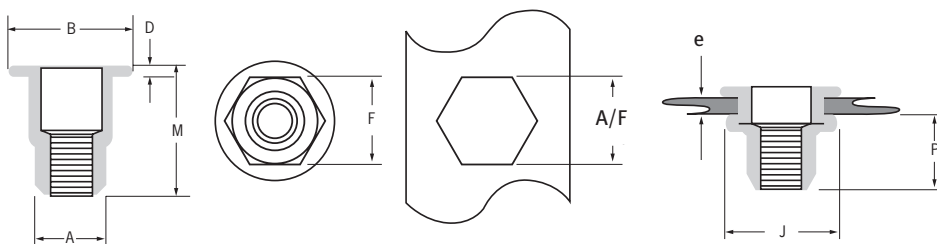

Ø	A/F		e (grip)		A ±0.08	B		D ±0.13	F ±0.08	J		M nom.	P max.	Part No/ref
	min.	max.	min.	max.		min.	max.			min.	max.			
M6 x 1.0	9.0	9.1	0.5	3.0	8.89	12.80	13.20	1.50	8.89	12.0	13.5	18.8	11.6	39301-26030
M8 x 1.25	11.0	11.1	0.5	3.0	10.89	15.68	16.28	1.50	10.89	14.0	16.2	20.4	13.8	39301-28030
M10 x 1.5	13.0	13.1	1.0	3.5	12.89	18.50	19.10	2.00	12.89	16.2	19.3	26.0	17.8	39301-20035
M12 x 1.75	16.0	16.1	1.0	4.0	15.88	22.60	23.30	2.25	15.90	19.0	24.2	30.8	22.0	39301-22040

all dimensions in mm / en millimètres / alle Maße in mm / in millimetri / en milímetros

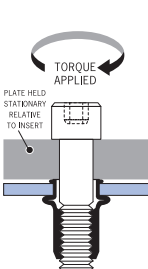
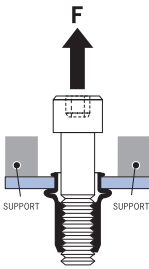
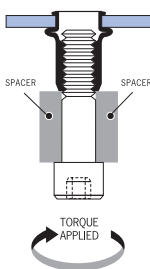
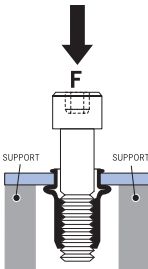
Ø	 Recommended max torque	 Pull-out	 Torque-to-turn		 Push-out
	max. Nm	e max. kN	e max. Nm	e min. Nm	e max. kN
M6 x 1.0	17.0	20.6	24.7	14.4	7.1
M8 x 1.25	60.0	28.1	34.6	15.6	10.7
M10 x 1.5	100.0	34.2	62.0	60.8	12.5
M12 x 1.75	135.0	40.9	135.0	62.0	18.3



**Avdel®**

An Acument™ Global Technologies Company

[www.avdel-global.com](http://www.avdel-global.com)

© 2007 Acument Intellectual Properties, LLC

Hexsert® is a trademark of Avdel UK Limited

02.2007

Data shown is subject to change without prior notice as a result of continuous product development and improvement policy.  
Your local Avdel representative is at your disposal should you need to confirm latest information.